

DRAG RACING CHASSIS

All drag racing chassis are kits including parts as shown tubing and rods are customer supplied

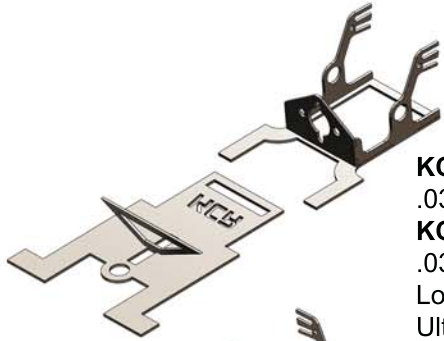

KCR1
.030" Spring Steel
KCR1-SS
.030" Stainless
Low Rear Axle
Ultra Skinny Nose

KCR15-SS
.030" 304 Stainless Steel
Low Rear Axle
Skinny Nose

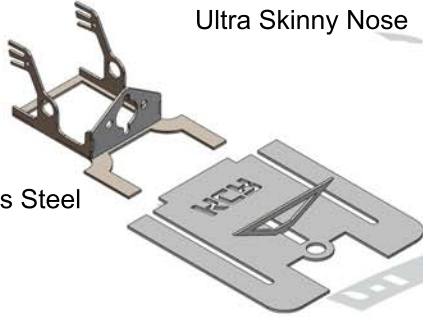

The Hard Tail rear mounts below can be mixed with a Heavy Duty nose for various chassis combinations



KCR16-Short
.030" Spring Steel
Low Rear Axle
For 1-1/16" Tires & Wheels
3/16" Bearing Holes
18 tooth pinion clearance



KCR16-Tall
.030" Spring Steel
Tall Rear Axle
For 1-3/16" Tires & Wheels
3/16" Bearing Holes
18 tooth pinion clearance

DRAG RACING CHASSIS

All drag racing chassis are kits including parts as shown tubing and rods are customer supplied



KCR13U
Ultra Skinny HD
.060" Steel
Weight - 17.3g

KCR13
Skinny HD
.060" Steel
Weight - 28.6g

KCR12
HD Nose
.060" Steel
Weight - 32.1g



KCR3 Dragster
.030" Spring Steel
Tall Rear Axle
For all Tires & Wheel sizes
3/16" Bearing Holes
18 tooth pinion clearance

KCR-MGW
Guide Weight
Brass
Weight: 5g



KCR-625BB
ID: 3/32"
OD: 3/16"
Flange: .234"
Stainless Ball
Shielded

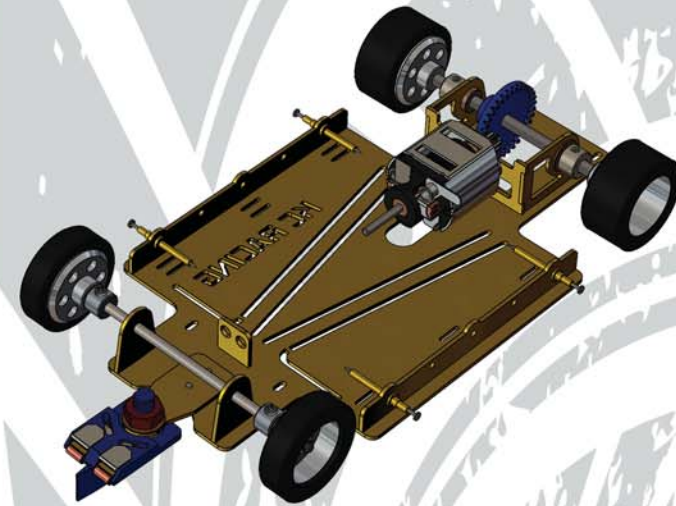
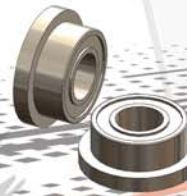

SLOT CAR CHASSIS & PARTS FOR PROFESSIONAL RACERS

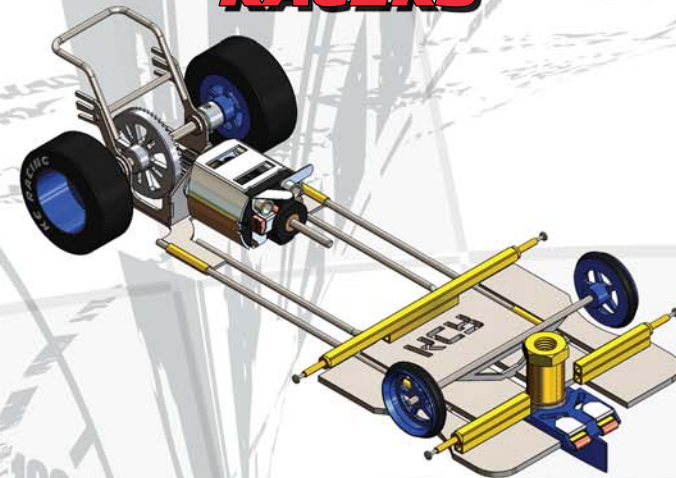

120722-500

© 2022

Post your completed cars on KC Racing's Facebook page at: www.facebook.com/groups/KCRacing

www.KCRacing.net

HARDBODY CHASSIS

The Lucky 7 Chassis

This is where it all began. Looking for a chassis that would give him an edge KC developed this hardbody chassis. It soon became a favorite among the local racers achieving lower lap times and superb handling. Racers around the world now use the Lucky 7 to gain an edge on the competition.

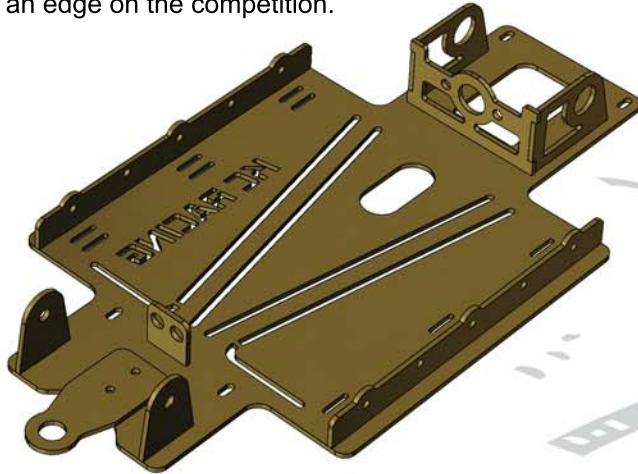

KCR-LC722

Material: .040" Brass
Weight: 79g

One kit provides for selection of 5 wheelbases, 3 body widths, 2 motor mounts

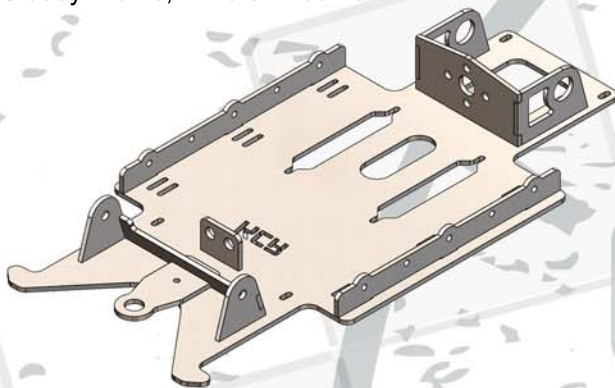

KCR-FB23

Material: .050" Stainless Steel
Weight: 97.6g

4.5" wheelbase, 3 body widths, 2 motor positions

Visit www.KCRacing.net for assembly information, tech tips and new products

CHASSIS PARTS

KCR-625

Bronze Bushing
ID: 3/32"
OD: 3/16"



KCR-623

Bronze Bushing
ID: 1/8"
OD: 1/4"

KCR-132M

Axle Collars
ID: 3/32"
OD: 1/4"
Width: 3/16"
Matl: 6061 Alum
Includes set screws



KCR-137M

Axle Collars
ID: 1/8"
OD: 1/4"
Width: 3/16"
Matl: 6061 Alum
Includes set screws

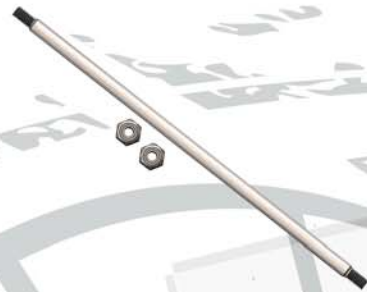

KCR-332FADR

Independent Axle
OD: 3/32"
Length: 3"
Matl: Drill Rod
Includes lock nuts

KCR-18218F

Milled Rear Axle
OD: 1/8"
Length: 2-1/4"
Matl: Drill Rod



KCR-18218

Round Rear Axle
OD: 1/8"
Length: 2-1/4"
Matl: Drill Rod

KCR-P4807-C4833

Hardbody Gear Set
Pitch: 48
Crown: 33 tooth
Matl: 6061 Aluminum
Finish: Blue Anodized
Pinion: 7 tooth
Matl: Steel
Includes set screw



CHASSIS PARTS

KCR-FBMS

Body Mounting System
Floating or Fixed
Matl: Brass
OD: 1/16"
ID: 1/32"



HARDWARE

KCR-484

Motor Mounting
Socket Head Capscrew
Sheetmetal Thread
5/64" socket



KCR-555

4-40 Set Screws
1/8" Long
Cup Point End

KCR-S321

.008" stainless guide shim

KCR-S332

.008" stainless 3/32" shim

KCR-S318

.008" stainless 1/8" shim

KCR-M24

Motor Mounting
Socket Head Capscrew
M2 Thread
for FK Motors



TOOLS

KCR-487

5/64" Hex
Designed for sheet metal
motor screws (KCR-484)



KC RACING

KCR-Tech Tool

Hardbody Tech Tool
Matl: Blue Acrylic
Thickness: .12"
Checks:
Height, Width, Tire diameter,
Front and Rear Tire Width

